

RONI - ASSOCIATED PRODUCTS

RONI
PISTOL-CARBINE CONVERSION

ASSEMBLING INSTRUCTIONS
RONI-G1 FOR GLOCK MODELS

MICRO T1

Aimpoint Micro T1, including the original 39mm spacer. Other Aimpoint sights available.



FFS/FRS

Low profile rear/front flip-up sights. Can be used as primary or back-up sights.

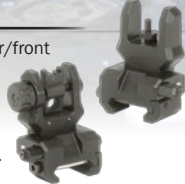

PLS1/34

Slim shape & low profile polymer Picatinny light/laser mount.
Diameter: 1" (25.4mm)/0.75" (19mm)
#PLS1/34 - screw tightened.
#PLS1Q/34Q - quick-release.



TC1

Vortex Tactical Flashlight 1 Watt Luxeon® LED. Water & Shock Resistant.



PBSS

Push button heavy duty sling swivel.



SIP/SQA

One or two point heavy duty sling uses #PBSS.



GLOCK MAGAZINES

(non original)
33, 17, 15 rounds.



BRASS-CATCHER

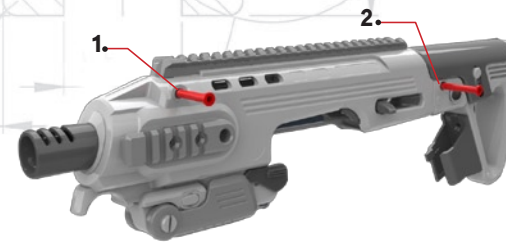

Step 1.

Pull the two safety pins out by pushing them thru the RONI (#1 & #2).



Step 2.

Pull the butt stock to full extension by pressing the button on the rear side of the stock (#3).

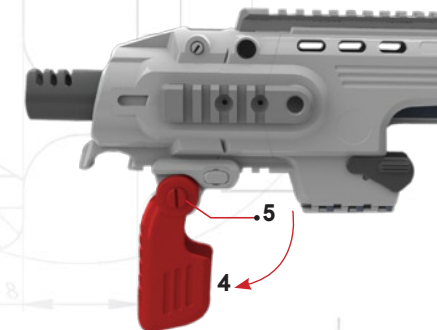

Step 3.

Open forearm-grip to vertical position (#4) by pushing release button (#5), and swinging grip down into position (if equipped with folding forearm-grip).



Step 4.

Lay the RONI down on its side. If you are looking at the pistol laying down, the muzzle should be pointing left. Slide parts #6 & #7 to fully extended positions.

www.caatactical.com info@caatactical.com

ENSURE THAT THE FIREARM IS NOT LOADED PRIOR TO INSTALLATION.
PRACTICE SAFE FIREARM HANDLING PROCEDURES AT ALL TIMES.
YOU MUST READ AND FOLLOW THE MANUAL. FOR MORE INFORMATION VISIT OUR WEBSITE.
ALL "C" GLOCK MODELS ARE PROHIBITED. THE INTEGRATED BELOW RAIL IS MANDATORY.



CAA
TACTICAL

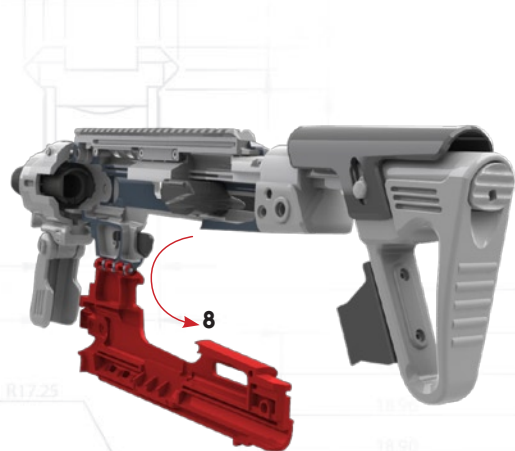

Step 5.

Open the body on its bottom hinge (#8).



Step 7.

Place pistol directly into position making sure it is laying flat. The under barrel rail slot on the Glock needs engage the male rail bar on the RONI.

In order for the RONI to close properly, make sure the pistol and slide attachment are locked into position before folding hinged body back over.



Step 6.

Place the polymer slide attachment (#9) to the rear of the slide.

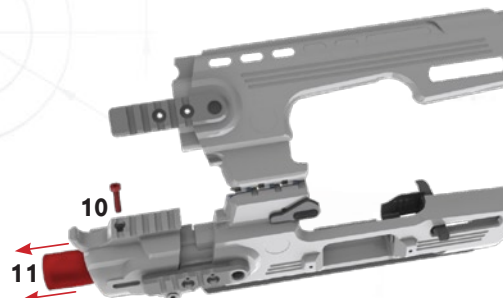

Step 8.

Changing between shorter Glock (such as 19, 23, 25, 32) to the longer version (such as 17, 22, 31, 34, 35), unscrew #10. Then, adjust #11 to the accurate position, so you can re-screw it securely. To be sure that the fitting is correct, you must insure the next step (#9).

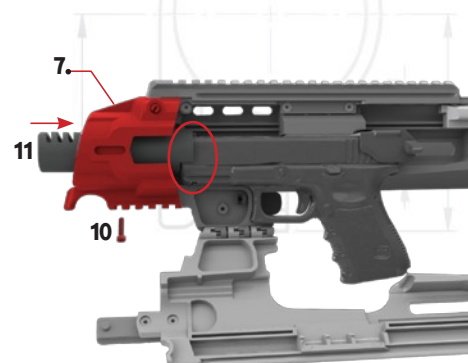

Step 9.

Push muzzle on RONI (#7) up against Glock. Make sure that part #11 covers the barrel of the pistol as pictured above and make sure the screw is well tightened (#10).



Step 10.

IMPORTANT: make sure that both safety-catches (#9) are locked at the same position.

Close the body (#8) and push parts #6 & #7 back together into locking position, then place pins back into place.

RONI FEATURES



- 9.4" (24cm) upper flattop rail - allows combinations of sight, magnifier or night vision.
- Three Picatinny rails for additional light/laser mounts.

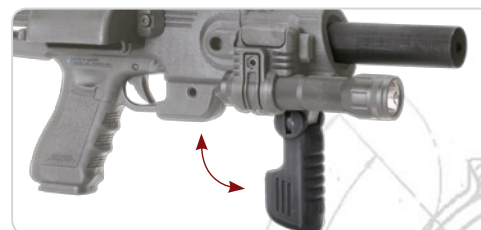

- Accepts silencers - up to 1.4" (35.5cm) diameter & brass-catcher.
- Includes detachable folding forearm grip.



- Pivoting safety catch for the trigger guard.
- Three Picatinny rails for additional light/laser mounts.



- Adjustable buttstock & cheek-rest.
- Spare magazine holder.